

Andy SkinnerThe Book Of Secrets

[HOME](#)

[WORKSHOP](#)

[MATERIALS](#)

[TESTIMONIALS](#)

[BLOG](#)

[WEBSITE](#)

[CONTACT](#)

[MORE...](#)

Book of Secrets Stage 2

Videos for stage 2

Adding Embellishments



Embellishments & Detail

We can now start adding some



We can now start adding some embellishments to the surface. This part is very much an individual process but I will show you the steps I go through.

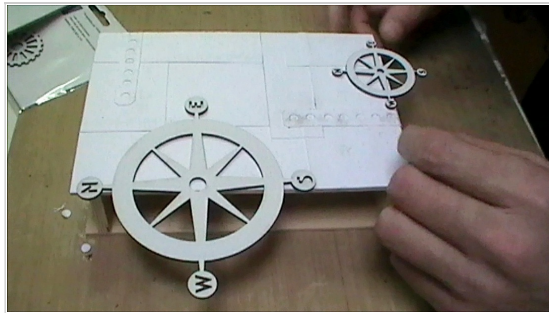

1. I start by placing my Tando compasses in position, I like to have them coming off the edge.

Once in position I hold them and turn the book over to mark with a pencil my cut line on the back of the chipboard.

Once marked I simply cut with a good pair of scissors.

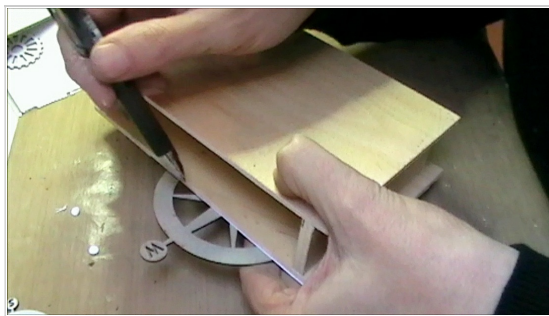

Repeat this process with the Tando cogs.

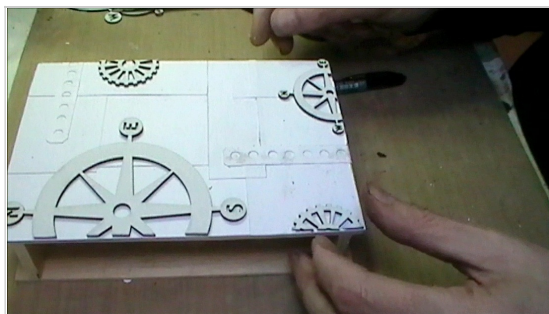

2. Using Ranger Glue & Seal Matte, the compasses and cogs are then glued into position.



Brush off any excess glue and seal that has seeped out from the edges

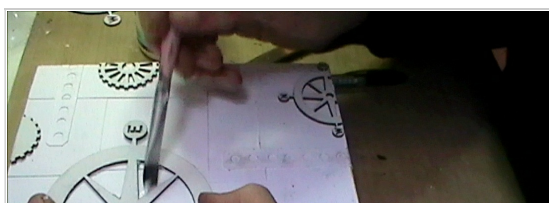

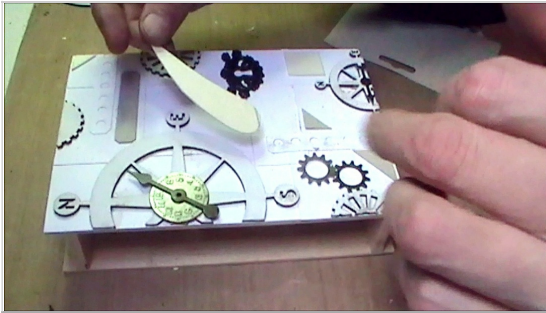

3. Next I cut a few shapes either from the 300gsm card, although I often use thicker cardboard for this effect and glue these into place.

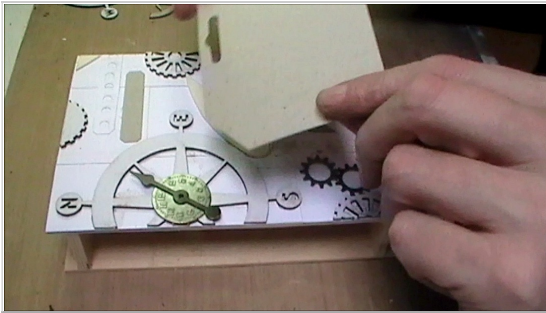

4. You can also use the card supplied in the Tando packaging.

The saved punched circles can now also be glued down to represent nail heads.

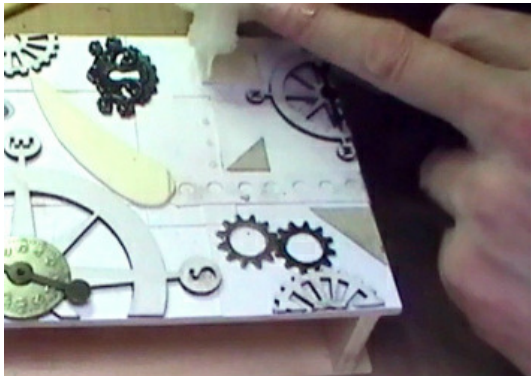

5. Glossy accents make great small rivets, I apply tiny beads in rows.

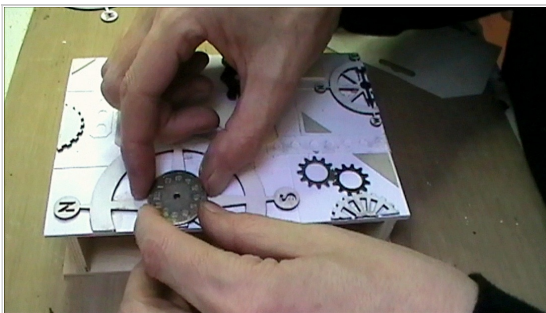

6. Its now time to glue your elements, the secret here is not to over do it. I often use elements from the Tim Holtz Idea-ology range, check out the link here for inspiration.

[Tim Holtz Idea-ology](#)



Use Glossy accents to glue the metal embellishments in place and allow to dry for a good hour.

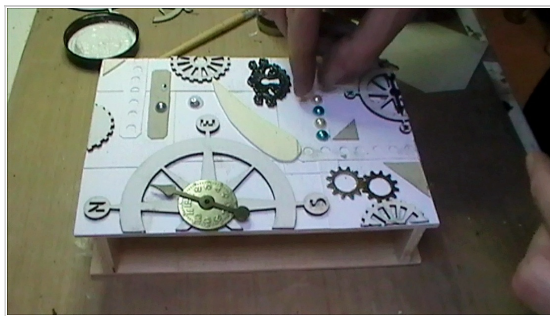

7. Now its time to start placing the faux rivets. For the rivets I use either goggle eyes or half pearls and adhere them to the surface of the card using the Glossy Accents.

It's a good idea to roughen the surface of the faux rivets and the metal embellishments with sandpaper first to help bond the acrylic paint to them.

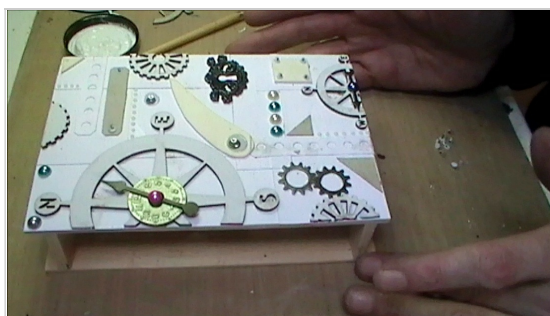

8. You should now have something that looks a little like this.

Its now time to tie all these elements together with acrylic paint!

Index

Stage 1 Preparation and applying the card

Stage 2 Adding embellishments

Stage 3 Back Cover

Stage 4 The spine

Stage 5 Dry Brushing Practice

Stage 6 Applying the first coats of acrylic

Stage 7 Dry brushing

Stage 8 Finishing

Copyright ©Andy Skinner 2011